

## 45819 XERTO EL 20W SE B

Facade luminaire

5905339900036



Kanlux XERTO is a minimalist LED facade luminaire with a movable module that allows you to direct light onto facades, terraces, or driveways. The color temperature is adjustable between 3000K/4000K/6500K, and the luminaire is available in versions without a sensor (IP65) and with a motion and twilight sensor (IP44). The sensor version offers a standard mode with adjustable lighting time and range, as well as a continuous mode. The luminaire is covered by a 3-year warranty, combining functionality with elegant design.

### PRODUCT PARAMETERS:

**Rated voltage [V]:** 220-240 AC

**Rated frequency [Hz]:** 50

**Maximum power [W]:** 20

**Luminous flux [lm]:** max 1800

**Lighting angle [°]:** 150

**Diode type:** LED SMD

**Integrated LED light source:** yes

**Correlated colour temperature [K]:** 3000 / 4000 / 6500

**Colour consistency in McAdam ellipses:** 6

**Colour temperature:** white, warm white, cold white

**Colour rendering index:** 80

**Service life [h]:** 25000

**Number of on/off cycles:** ≥20000

**Colour:** black

**Place of assembly:** wall mounted

**Place of application:** outdoors

**IP class:** 44

**Minimum distance from the illuminated object:** 0,5m

**Compatible with a dimmer:** no

**Fixture lighting direction:** down

**Width [mm]:** 232

**Height [mm]:** 117

**Class of protection against electric shock:** I

**Lampshade material:** PC

**Enclosure material:** aluminum alloy

**Protective glass material:** plastic

**Ambient temperature range to which the product can be exposed:** -20÷35

## 45819 XERTO EL 20W SE B

Facade luminaire

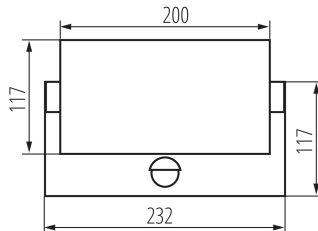

**Sensor type:** PIR

**Sensor range[m]:** 8

**Sensor working angle [°]:** 110

**Sensor-operation time [second-minute]:** 10-10

**Wykrywanie ruchu:** yes

**Connection type:** Bolt terminal block

**Range of sections of wires used [mm²]:** 1

**The fixture is movable vertically [°]:** 320

**Kształt:** rectangular

**LED light source replaceability:** The LED light source can only be replaced by qualified personnel (Kanlux service only)

**Control gear replaceability:** Any control panel or control equipment can only be replaced by qualified personnel (Kanlux service only)

**Product category according to 2019/2020/EU:** Containing product (CP)

### PARAMETERS FOR LED AND OLED LIGHT SOURCES:

**Energy efficiency class of the light source in the contains product (CP):** E

**Number of modules (LED light source):** 1

**Chromaticity coordinates (x):** 0,38

**Chromaticity coordinates (y):** 0,38

**R9 colour rendering index value :** 0

**Survival factor:** 0,9

**The lumen maintenance factor:** 0,96

**Lighting technology used:** LED

**Non-directional or directional light source :** NDLS

**Mains or non-mains light source :** NMLS

**Connected light source (CLS):** no

**Colour-tuneable light source:** no

**High luminance light source:** no

**Anti-glare shield :** no

**Dimmable:** no

### LOGISTIC DATA:

**Unit of measurement:** unit

**Packaging method:** 6

**Number of units in the secondary packaging :** 1

**Number of units in the packaging :** 6

**Net unit weight [g]:** 1256

**Grammage [g]:** 1526.67

## 45819 XERTO EL 20W SE B

Facade luminaire

Gross unit weight [g] : 1450  
Length of a unit pack [cm] : 20.5  
Width of a unit pack [cm] : 14.5  
Height of a unit pack [cm] : 28.5  
Weight of a cardboard box [kg] : 9.16002  
Width of a cardboard box [cm] : 30.5  
Height of a cardboard box [cm] : 30  
Length of a cardboard box [cm] : 63  
Volume of a cardboard box [m<sup>3</sup>] : 0.057645

### ADDITIONAL INFORMATION:

-