

## 33070 REXAR LED W

### LED desk lamp



Kanlux REXAR desk lamp combines a minimalist, elegant design and plenty of functions. You can adjust the colour of the light and its intensity to suit your preferences, as well as use the USB port in order to charge a mobile device. Once it is switched off, a folded lamp does not occupy much space and serves as an uncluttered decoration.

#### GENERAL DATA:

**Colour:** white

**Place of assembly:** On the floor

**Place of application:** Indoors

**Minimum distance from the illuminated object:** 0,1m

**Built-in brightness control:** yes

**Compatible with a dimmer:** no

**On switch:** yes

**Length [mm]:** 180

**Width [mm]:** 140

**Height MAX [mm]:** 715

**Cable length [m]:** 1.8

**Integrated LED light source:** yes

**USB port:** gniazdo USB-A z funkcją ładowania urządzeń mobilnych

#### TECHNICAL DATA:

**Rated voltage [V]:** 220-240 AC

**Rated frequency [Hz]:** 50

**Maximum power [W]:** max 7

**Class of protection against electric shock:** II

**Lampshade material:** aluminum alloy, plastic

**Diode type:** LED SMD

**Luminous flux [lm]:** max 420

**Useful luminous flux of the light source  $\Phi_{use}$  [lm]:** 650

**Useful luminous flux of the light source  $\Phi_{use}$  [lm]:** in sphere (360°)

**Colour temperature:** Warm white, white, cold white

**Correlated colour temperature [K]:** 3000/4000/6500

**Colour consistency in McAdam ellipses:**  $\leq 6$

**Colour rendering index:** 80

**Service life [h]:** 25000

**Number of on/off cycles:**  $\geq 15000$

**Lighting angle [°]:** 100

**Luminous efficiency of the lamp [lm/W]:** max 60

**Enclosure material:** aluminum alloy, plastic

## 33070 REXAR LED W

LED desk lamp

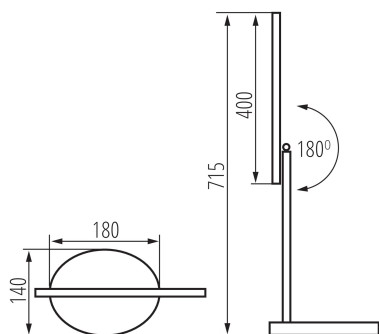

**Connection type:** Cable terminated with a plug

**Lamp-heating time [s]:**  $\leq 1$

**Lamp-ignition time [s]:**  $\leq 0,5$

**The fixture is movable vertically [°]:** 180

**IP class:** 20

