

19761 GAVI LED18 SMD-WW-C/M

LED spotlight fitting for furniture units

5905339197610

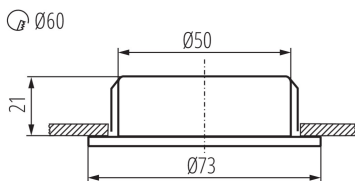

Kanlux GAVI LED are furniture fittings made of glass and steel. Unpretentious colour scheme allows them to discretely fit into the place of assembly. Kanlux GAVI LED holders have an integrated source of light

GENERAL DATA:

Colour: chrome matte
Place of assembly: Recessed mount in the ceiling
Place of application: Indoors
Minimum distance from the illuminated object: 0,1m
Compatible with a dimmer: no
Diameter [mm]: 73
Assembly hole [mm]: Ø60
Integrated LED light source: yes

TECHNICAL DATA:

Rated voltage [V]: 12 DC
Maximum power [W]: 0,8
Class of protection against electric shock: III
Diode type: LED SMD
Luminous flux [lm]: 42
Colour temperature: Warm white
Correlated colour temperature [K]: 3000
Colour consistency in McAdam ellipses: ≤6
Colour rendering index: 80
Service life [h]: 30000
Number of on/off cycles: ≥15000
Luminous efficiency of the lamp [lm/W]: 53
Ambient temperature range to which the product can be exposed: 5÷25
Enclosure material: steel
Connection type: Free cable ends
Wire length [m]: 0.14
Lamp-heating time [s]: ≤1
Lamp-ignition time [s]: ≤0,5
IP class: 20

LOGISTIC DATA:

Packaging method: 10
Number of units in the secondary packaging: 10
Number of units in the packaging: 100
Net unit weight [g]: 65
Grammage [g]: 86.1
Length of a unit pack [cm]: 7.5
Width of a unit pack [cm]: 2.5

19761 GAVI LED18 SMD-WW-C/M

LED spotlight fitting for furniture units

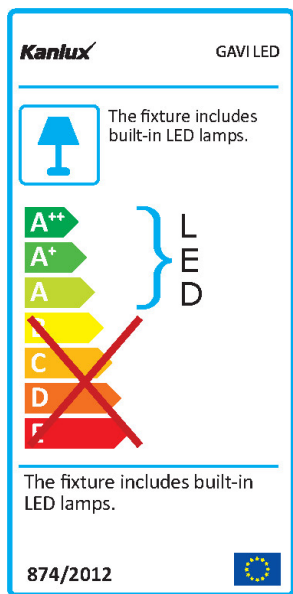

Height of a unit pack [cm]: 8
Weight of a cardboard box [kg]: 8.61
Width of a cardboard box [cm]: 32
Height of a cardboard box [cm]: 17
Length of a cardboard box [cm] : 39
Volume of a cardboard box [m³]: 0.021216

ADDITIONAL INFORMATION:

- an electronic 350-mA DC power supply unit is required for proper functioning, e.g. ADI 350 or RICO available from Kanlux

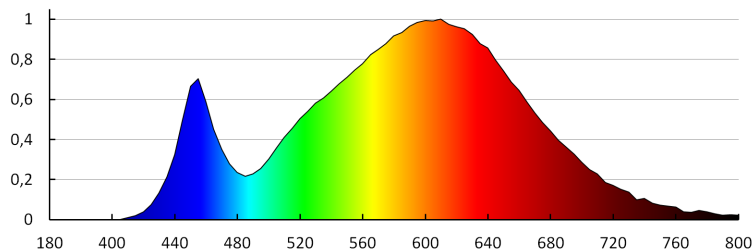

KANLUX S.A. (kat 19760) GAVI LED18 SMD / Krzywa rozsytu światła (biegunowo)

Oprawa: KANLUX S.A. (kat 19760) GAVI LED18 SMD
 Lampy: 1 x GAVI LED18 SMD

