

## 22117 MORTA B CT-DSO50-SR

Ceiling-mounted spotlight fitting

5905339221179



MORTA B CT-DSL50-B

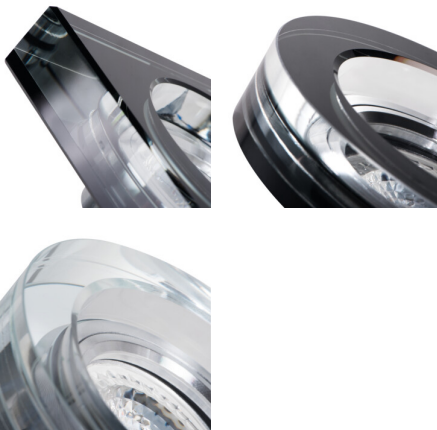

A wide range of the Kanlux MORTA holder models will allow making very original arrangements in each house. Kanlux MORTA meet expectations of everyone that highly values products of high quality, characterized by attractive and original design.

### GENERAL DATA:

**Colour:** silver

**Necessity of using self-shielding lamps :** yes

**Place of assembly:** Recessed mount in the ceiling

**Place of application:** Indoors

**Minimum distance from the illuminated object :** 0,5m

**The product is not suitable to be installed on a normally flammable surface:** >35W

**The product is not suitable to be covered with a heat-insulating material:** yes

**Height [mm]:** 36

**Diameter [mm]:** 90

**Assembly hole [mm]:** Ø65-70

### TECHNICAL DATA:

**Rated voltage [V]:** 12 AC; 12 DC

**Maximum power [W]:** max 10

**Class of protection against electric shock :** III

**Light source :** MR16

**Light source included:** no

**Cap:** Gx5,3

**Ambient temperature range to which the product can be exposed:** 5÷25

**Enclosure material:** glass

**Connection type:** Free cable ends

**Wire length [m]:** 0.12

**Wire diameter [mm<sup>2</sup>]:** 0.75

**Lighting-fixture angle regulation :** none

**IP class:** 20

### LOGISTIC DATA:

**Unit of measurement:** unit

**Packaging method:** 30

**Number of units in the secondary packaging :** 1

**Number of units in the packaging :** 30

**Number of units per layer on a pallet :** 210

**Net unit weight [g] :** 210

**Grammage [g]:** 245.33

## 22117 MORTA B CT-DSO50-SR

Ceiling-mounted spotlight fitting

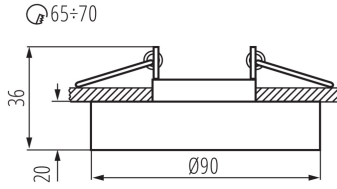

Length of a unit pack [cm]: 10

Width of a unit pack [cm]: 4.5

Height of a unit pack [cm]: 10

Weight of a cardboard box [kg]: 7.3599

Width of a cardboard box [cm]: 24.5

Height of a cardboard box [cm]: 22

Length of a cardboard box [cm]: 32

Volume of a cardboard box [m<sup>3</sup>]: 0.017248

