

Wall & ceiling lighting fitting

5905339349231



MO
DE
RN
design



Kanlux SONDA II is a modern lamp series in which you can choose from 1 to 4 points of light. The modern shape of these luminaires will constitute a unique decoration of any interior. An additional advantage of Kanlux SONDA II lamps is the extremely elegant finish of the lampshade that hides the edges of the source of light so that only the bulb lens is visible.

GENERAL DATA:

Colour: white

Place of assembly: wall mounted, ceiling mounted

Place of application: Indoors

Minimum distance from the illuminated object: 0,5m

Length [mm]: 250

Width [mm]: 60

Height [mm]: 150

TECHNICAL DATA:

Rated voltage [V]: 220-240 AC

Rated frequency [Hz]: 50

Maximum power [W]: 2 x max 10

Class of protection against electric shock: I

Light source: PAR16

Light source included: no

Cap: GU10

Ambient temperature range to which the product can be exposed: 5÷25

Enclosure material: aluminum alloy

Connection type: Bolt terminal block

Range of sections of wires used [mm²]: 1÷2,5

The fixture is movable horizontally [°]: 330

The fixture is movable vertically [°]: 120

IP class: 20

LOGISTIC DATA:

Packaging method: 10

Number of units in the secondary packaging: 1

Number of units in the packaging: 10

Net unit weight [g]: 626

Grammage [g]: 750

Length of a unit pack [cm]: 16

Width of a unit pack [cm]: 6.5

Height of a unit pack [cm]: 26

Weight of a cardboard box [kg]: 7.5

Width of a cardboard box [cm]: 33.5

Height of a cardboard box [cm]: 28

34923 SONDA II EL-2I W

Wall & ceiling lighting fitting

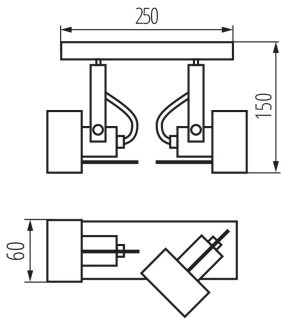

Length of a cardboard box [cm] : 34.5

Volume of a cardboard box [m³]: 0.032361

