

22840 HIMA MCOB 30W-NW-W

Downlight fitting

5905339228406

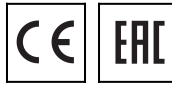
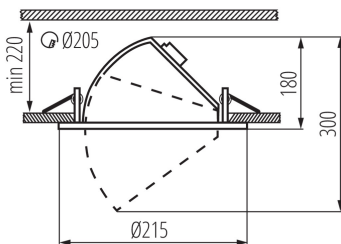

Kanlux HIMA is a white holder of downlight type. It is distinguished by a possibility of very large adjustment of the angle and durability up to 30 000 hours. Modern design of the holder is its additional asset.

GENERAL DATA:

Colour: white

Place of assembly: Recessed mount in the ceiling

Place of application: Indoors

Minimum distance from the illuminated object: 0,5m

Compatible with a dimmer: no

Replaceable light source: no

Height [mm]: 180

Diameter [mm]: 215

Assembly hole [mm]: Ø205

Integrated LED light source: yes

TECHNICAL DATA:

Rated voltage [V]: 220-240 AC

Rated frequency [Hz]: 50/60

Maximum power [W]: 30

Class of protection against electric shock: II

Lampshade material: glass

Diode type: LED MCOB

Luminous flux [lm]: 2100

Colour temperature: white

Colour temperature [K]: 4000

Colour uniformity [SDCM]: ≤6

Colour-rendering index Ra: ≥80

Service life [h]: 30000

Number of on/off cycles: ≥15000

Lighting angle [°]: 45

Luminous efficiency of the lamp [lm/W]: 70

Ambient temperature range to which the product can be exposed: 5÷25

Enclosure material: aluminum alloy

The fixture set includes built-in LED's with the following energy classes: A++,A+,A

Lamp-heating time [s]: ≤1

Lamp-ignition time [s]: ≤0,5

The fixture is movable horizontally [°]: 350

The fixture is movable vertically [°]: 50

IP class: 20

LOGISTIC DATA:

Downlight fitting

Kanlux HIMA MCOB 30W-NW-W

W skład oprawy wchodzi w budowane lampy LED.

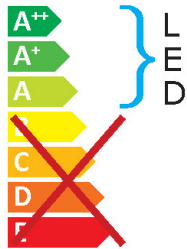

L
E
D

Nie można wymienić lamp w oprawie.

874/2012 



Jednostka miary: sztuka

Jak pakowane: 8

Ilość sztuk w opakowaniu pośrednim: 1

Ilość sztuk w opakowaniu zbiorczym: 8

Masa jednostkowa netto [g]: 1740

Gramatura [g]: 1885

Długość opakowania jednostkowego [cm]: 22

Szerokość opakowania jednostkowego [cm]: 22

Wysokość opakowania jednostkowego [cm]: 20

Waga kartonu [kg]: 15.08

Szerokość kartonu [cm]: 45

Wysokość kartonu [cm]: 42.5

Długość kartonu [cm]: 45.5

Objętość kartonu [m³]: 0.087019

ADDITIONAL INFORMATION:

- power supply unit included
- angular adjustment

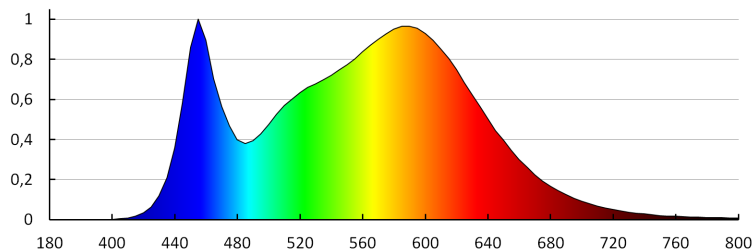

KANLUX S.A. (kat 22840) HIMA MCOB 30W / Krzywa rozsyłu światła (biegunowo)

Oprawa: KANLUX S.A. (kat 22840) HIMA MCOB 30W
Lampy: 1 x HIMA MCOB 30W

