

22591 TEAR PR-X-WH

Accessory for electrical supply track systems

5905339225917



PRODUCT PARAMETERS:

Colour: white

Place of assembly: rail TEAR

Place of application: Indoors

Rated voltage [V]: 220-240 AC

Rated current [A]: 16

Rated frequency [Hz]: 50

Class of protection against electric shock: I

Ambient temperature range to which the product can be exposed: 5÷25

Enclosure material: plastic

IP class: 20

LOGISTIC DATA:

Packaging method: 10

Number of units in the secondary packaging: 1

Number of units in the packaging: 10

Net unit weight [g]: 268

Grammage [g]: 306

Length of a unit pack [cm]: 18

Width of a unit pack [cm]: 18

Height of a unit pack [cm]: 3.5

Weight of a cardboard box [kg]: 3.06

Width of a cardboard box [cm]: 17.5

Height of a cardboard box [cm]: 21

Length of a cardboard box [cm]: 29

Volume of a cardboard box [m³]: 0.010658

ADDITIONAL INFORMATION:

- TEAR PR-X: designed for connecting four busbar sections into an X shape

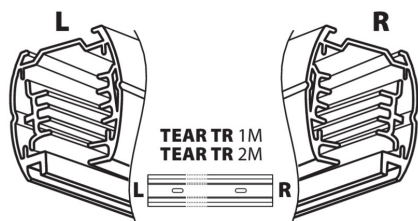
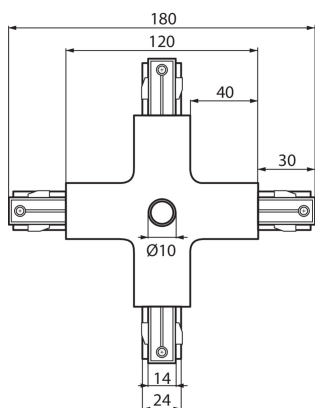

22591 TEAR PR-X-WH

Accessory for electrical supply track systems

