

26771 AVAR 6060 40W-CW

LED lighting frame

5905339267719

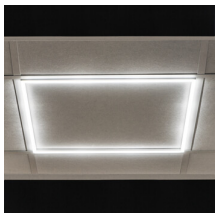

LED panels are very popular lighting elements in office interiors. Due to their durability, energy efficiency and aesthetics, they have replaced extent raster luminaires to a large. Kanlux AVAR LED is a new dimension in LED panels distinguished by modern technology and the shape of frame which emits intense and impressive light.

PRODUCT PARAMETERS:

Colour: white

Place of assembly: Recessed mount in the ceiling

Place of application: Indoors

Minimum distance from the illuminated object: 0,5m

Compatible with a dimmer: no

The product is not suitable to be covered with a heat-insulating material: yes

Feeder included: yes

Length [mm]: 591

Width [mm]: 591

Height [mm]: 14

Integrated LED light source: yes

Rated voltage [V]: 220-240 AC

Rated frequency [Hz]: 50

Maximum power [W]: 40

Class of protection against electric shock: II

Lampshade material: plastic

Enclosure material: aluminum alloy

Panel/frame material: aluminum alloy

Diode type: LED SMD

Luminous flux of the light fitting [lm]: 3800

Colour temperature: cold white

Service life [h]: 25000

Number of on/off cycles: ≥ 15000

Lighting angle [°]: 110

Ambient temperature range to which the product can be exposed: 5÷25

Shade type: opal

Connection type: Terminal block

Range of sections of wires used [mm²]: 0,75

IP class: 20

Kształt: square

26771 AVAR 6060 40W-CW

LED lighting frame

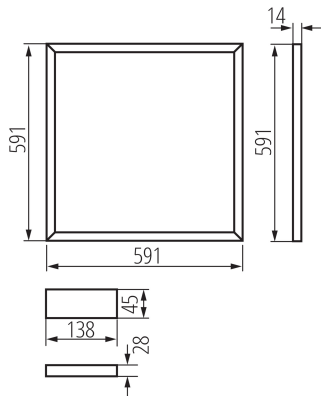

Additional information: The LED light source can only be replaced by qualified personnel (Kanlux service only)

Additional information: The control panel or control equipment can be replaced by the end user

Additional information: Containing product (CP)

Luminous efficiency of the lamp [lm/W]: 95

PARAMETERS FOR LED AND OLED LIGHT SOURCES:

Energy efficiency class: E

Energy efficiency class of the light source in the contains product (CP): E

Number of modules (LED light source): 1

Useful luminous flux of the light source Φ_{use} [lm]: 5200

Useful luminous flux of the light source Φ_{use} [lm]: in sphere (360°)

Correlated colour temperature [K]: 6000

Colour consistency in McAdam ellipses: ≤6

Colour rendering index: 80

LOGISTIC DATA:

Unit of measurement: unit

Packaging method: 10

Number of units in the secondary packaging: 1

Number of units in the packaging: 10

Net unit weight [g]: 480

Grammage [g]: 880

Length of a unit pack [cm]: 62

Width of a unit pack [cm]: 3

Height of a unit pack [cm]: 62

Weight of a cardboard box [kg]: 8.8

Width of a cardboard box [cm]: 34

Height of a cardboard box [cm]: 63.5

Length of a cardboard box [cm]: 63.5

Volume of a cardboard box [m³]: 0.137097

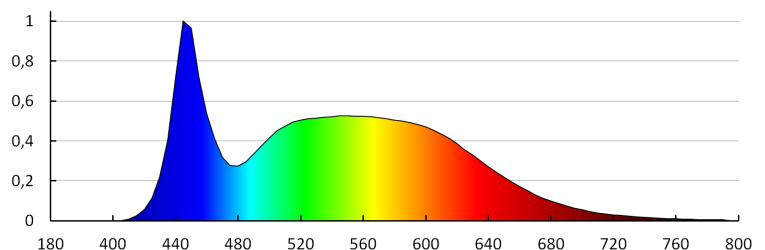

26771 AVAR 6060 40W-CW

LED lighting frame

KANLUX S.A. (kat 26771) AVAR 6060 40W-CW / LDC (Polar)

Luminaire: KANLUX S.A. (kat 26771) AVAR 6060 40W-CW
Lamps: 1 x AVAR 6060 40W-CW

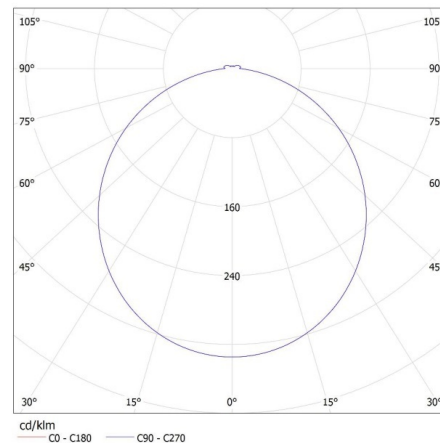

ACCESSORIES

28512

AVAR DALI SET 40W

Set containing accessories and a power supply unit enabling communication in line with DALI protocol (28512)

