

27391 ONTEC R M2 302 M ST/W

Emergency lighting LED

5902052556762

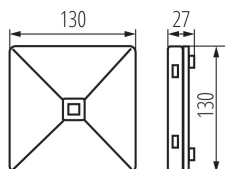

Emergency or anti-panic lighting is used in open space rooms to prevent panic. It allows you to reach a place where you can see the marked escape route as well as for the illumination of the escape route itself, depending on the prism used in the fixture.

PRODUCT PARAMETERS:**Colour:** white**Place of assembly:** wall mounted, ceiling mounted**Place of application:** Indoors**Width [mm]:** 130**Height [mm]:** 27**Integrated LED light source:** yes**Rated voltage [V]:** 220-240 AC**Rated frequency [Hz]:** 50**Rated power (LED) [W]:** 2**Class of protection against electric shock:** II**Lampshade material:** plastic**Diode type:** LED SMD**Luminous flux [lm]:** 288**Luminous flux [lm] (emergency-lighting module):** 288**Colour temperature:** cold white**Ambient temperature range to which the product can be exposed:** 10÷35**Battery (type):** LiFePO4/C**Battery (parameters):** 6.4V**Operating mode:** emergency and network**Application:** anti-panic lighting**Fail-safe working time [h]:** 3**Standard test:** yes**Enclosure material:** plastic**Connection type:** Self-clamping block**IP class:** 20**PARAMETERS FOR LED AND OLED LIGHT SOURCES:****Correlated colour temperature [K]:** 5000**LOGISTIC DATA:****Packaging method:** 1**Number of units in the secondary packaging:** 1**Number of units in the packaging:** 1**Net unit weight [g]:** 240**Grammage [g]:** 282**Length of a unit pack [cm]:** 13.5**Width of a unit pack [cm]:** 4**Height of a unit pack [cm]:** 13.5

27391 ONTEC R M2 302 M ST/W

Emergency lighting LED

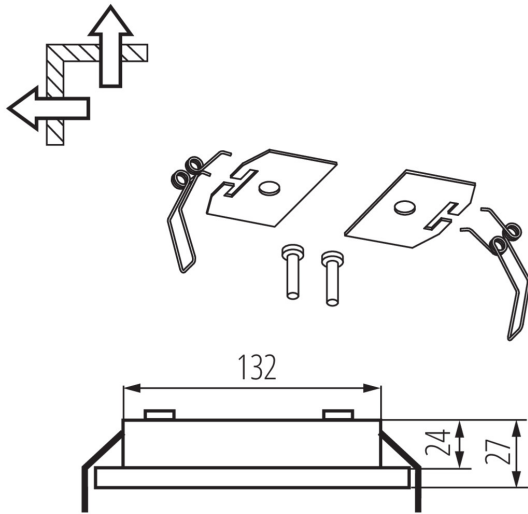
**Weight of a cardboard box [kg]:** 0.282**Width of a cardboard box [cm]:** 15**Height of a cardboard box [cm]:** 29**Length of a cardboard box [cm] :** 21**Volume of a cardboard box [m³]:** 0.009135**ADDITIONAL INFORMATION:**

- Fail-safe working time [h]: 3 Operating mode: maintained