

29581 AREL LED DO 6W-WW

Downlight fitting

5905339295811

IP
65/20

ultra
SLIM
panel

HIGH
quality



Kanlux AREL LED is a new family of downlights which do not have frame. High tightness class IP65/20 and exceptional, simple, and at the same time surprising design make Kanlux AREL LED fit into each interior. Thanks to the unique structure, the panel is only 9 mm thick - it is the thinnest panel available on the market.

TYPE OF LIGHT SOURCE:

Lighting technology used: LED

Non-directional or directional light source: NDLS

Mains or non-mains light source: NMLS

Connected light source (CLS): no

Colour-tuneable light source: no

High luminance light source: no

Anti-glare shield: no

Dimmable: no

PRODUCT PARAMETERS:

Colour: white

Place of assembly: Recessed mount in the ceiling

Place of application: Indoors

Minimum distance from the illuminated object: 0,5m

Compatible with a dimmer: no

The product is not suitable to be covered with a heat-insulating material: yes

Height [mm]: 23

Diameter [mm]: 75

Assembly hole [mm]: Ø60

Integrated LED light source: yes

Rated voltage [V]: 220-240 AC

Rated frequency [Hz]: 50

Maximum power [W]: 6

Class of protection against electric shock: II

Lampshade material: PMMA

Diode type: LED SMD

LED module: DL-4014-06P06S-482060-0R75-V35 ID33239 92387

Luminous flux [lm]: 440

Colour temperature: Warm white

Service life [h]: 15000

Number of on/off cycles: ≥30000

Lighting angle [°]: 120

Ambient temperature range to which the product can be exposed: 5÷25

Enclosure material: aluminum alloy

29581 AREL LED DO 6W-WW

Downlight fitting

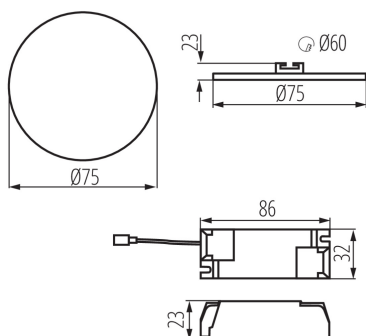
**Connection type:** Terminal block**Range of sections of wires used [mm²]:** 0,75-1,5**Lamp-heating time [s]:** ≤1**Lamp-ignition time [s]:** ≤0,5**IP class:** 65/20**Additional information:** It is not possible to replace the LED light source**Additional information:** The control panel or control equipment can be replaced by the end user**PARAMETERS FOR LED AND OLED LIGHT SOURCES:****Energy consumption in on-mode of the light source (kWh/1000h):** 5**Energy efficiency class:** D**Useful luminous flux of the light source Φ_{use} [lm]:** 650**Useful luminous flux of the light source Φ_{use} [lm]:** in sphere (360°)**Correlated colour temperature [K]:** 3000**Colour consistency in McAdam ellipses:** ≤6**On-mode power of the light source P_{on} [W]:** 4.3**Height of the light source [mm]:** 206**Width of the light source [mm]:** 5**Depth of the light source [mm]:** 1**Colour rendering index:** 80**Chromaticity coordinates (x):** 0.44**Chromaticity coordinates (y):** 0.403**Claim of equivalent power [W]:** 50**R9 colour rendering index value:** 2**Survival factor:** 0,9**The lumen maintenance factor:** 0,93**LOGISTIC DATA:****Packaging method:** 100**Number of units in the packaging:** 100**Net unit weight [g]:** 90**Grammage [g]:** 122**Length of a unit pack [cm]:** 10.5**Width of a unit pack [cm]:** 3**Height of a unit pack [cm]:** 11**Weight of a cardboard box [kg]:** 12.2**Width of a cardboard box [cm]:** 23**Height of a cardboard box [cm]:** 24.5**Length of a cardboard box [cm]:** 78**Volume of a cardboard box [m³]:** 0.043953

29581 AREL LED DO 6W-WW

Downlight fitting

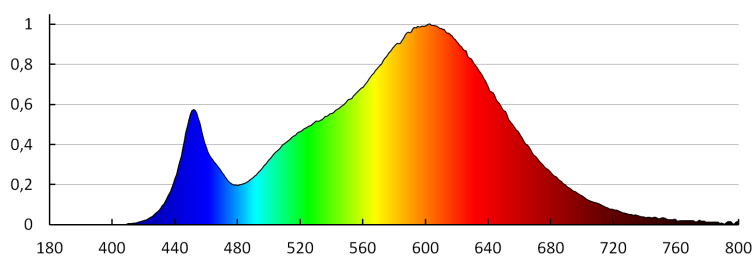

KANLUX S.A. (kat 29581) AREL LED DO 6W-WW / LDC (Polar)

Luminaire: KANLUX S.A. (kat 29581) AREL LED DO 6W-WW
Lamps: 1 x AREL LED DO 6W-WW

