

29856 APUS LED PIR B-NW

Staircase LED light fitting

5905339298560

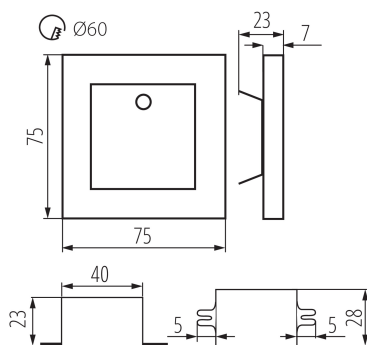
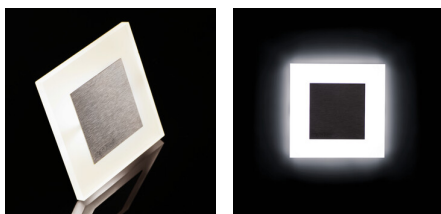

Kanlux APUS means modern design combined with an attractive effect of lighting. It is a perfect idea to highlight stairs and corridors or to emphasize decor of rooms. The unique structure of the holders ensures even emission of light. The AC version is equipped with 230V power supply unit which fits into a box and the PIR version is equipped with a motion sensor. The sensor detects movement / turns lights on regardless of the ambient light intensity.

PRODUCT PARAMETERS:

To be built into the wall : yes

Colour: black

Place of assembly: Recessed mount in the wall

Place of application: Indoors

Minimum distance from the illuminated object : 0,1m

Compatible with a dimmer: no

Wykrywanie ruchu: yes

Length [mm]: 75

Width [mm]: 23

Height [mm]: 75

Required diameter of the assembly box [Ømm]: 60

Assembly-hole dimensions [mm]: 60

Integrated LED light source : yes

Rated voltage [V]: 12 DC

Maximum power [W]: 0.8

Class of protection against electric shock : III

Lampshade material: plastic

Diode type: LED SMD

Luminous flux [lm]: 14

Colour temperature: white

Service life [h]: 50000

Number of on/off cycles: ≥20000

Ambient temperature range to which the product can be exposed: 5÷25

Enclosure material: polished stainless steel, plastic

Sensor type: PIR

Connection type: Free cable ends

Wire length [m]: 0.18

Sensor-operation time [second-minute]: 60--

Lamp-heating time [s]: ≤1

Lamp-ignition time [s]: ≤0,5

sensor working angle [°]: H90/V40

IP class: 20

Sensor range[m]: max 5

29856 APUS LED PIR B-NW

Staircase LED light fitting



Additional information: nie podlega pod rozporządzenie 2019/2020

Luminous efficiency of the lamp [lm/W]: 18

PARAMETERS FOR LED AND OLED LIGHT SOURCES:

Correlated colour temperature [K]: 4000

Colour consistency in McAdam ellipses: ≤6

Colour rendering index: 80

LOGISTIC DATA:

Unit of measurement: unit

Packaging method: 100

Number of units in the secondary packaging: 1

Number of units in the packaging: 100

Net unit weight [g]: 84

Grammage [g]: 102.9

Gross unit weight [g]: 98

Length of a unit pack [cm]: 11

Width of a unit pack [cm]: 2.5

Height of a unit pack [cm]: 16.5

Weight of a cardboard box [kg]: 10.29

Width of a cardboard box [cm]: 24

Height of a cardboard box [cm]: 34.5

Length of a cardboard box [cm]: 63.5

Volume of a cardboard box [m³]: 0.052578