

33750 DULI LED 4W-NW-L-GR

Surface-mounted light fitting

5905339337504

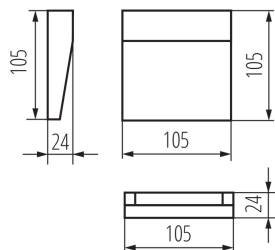
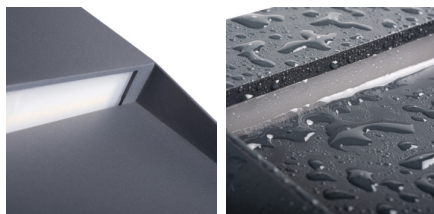

Kanlux DULI LED is a series of surface-mounted, façade luminaires. Modern and geometric design in a simple form makes this series very universal. A matte graphite finish and the most popular colour temperature for architectural luminaires (4000K) are other advantages. Kanlux DULI LED is decorative accent lighting that illuminates spaces around the building. Kanlux DULI LED surface-mounted luminaires are powered by 230V without using an additional power supply unit.

TYPE OF LIGHT SOURCE:

Lighting technology used: LED
Non-directional or directional light source: NDLS
Mains or non-mains light source: NMLS
Connected light source (CLS): no
Colour-tunable light source: no
High luminance light source: no
Anti-glare shield: no
Dimmable: no

PRODUCT PARAMETERS:

Colour: anthracite
Place of assembly: wall mounted
Place of application: Indoors and outdoors
Minimum distance from the illuminated object: 0,2m
Compatible with a dimmer: no
RAL: 7016
Width [mm]: 105
Height [mm]: 105
Depth [mm]: 24
Integrated LED light source: yes
Rated voltage [V]: 220-240 AC
Rated frequency [Hz]: 50
Maximum power [W]: 4
Class of protection against electric shock: I
Diode type: LED SMD
Luminous flux [lm]: 100
Colour temperature: white
Service life [h]: 30000
Number of on/off cycles: ≥ 25000
Ambient temperature range to which the product can be exposed: -15÷35
Enclosure material: aluminum alloy
Protective glass material: PC
Connection type: Terminal block

33750 DULI LED 4W-NW-L-GR

Surface-mounted light fitting



Range of sections of wires used [mm²]: 0,75-1,5

Lamp-heating time [s]: ≤1

Lamp-ignition time [s]: ≤0,5

IP class: 54

Additional information: The LED light source can only be replaced by qualified personnel (Kanlux service only)

Additional information: Any control panel or control equipment can only be replaced by qualified personnel (Kanlux service only)

PARAMETERS FOR LED AND OLED LIGHT SOURCES:

Energy efficiency class: D

Useful luminous flux of the light source Φ_{use} [lm]: 470

Useful luminous flux of the light source Φ_{use} [lm]: in sphere (360°)

Correlated colour temperature [K]: 4000

Colour consistency in McAdam ellipses: ≤6

Colour rendering index: 80

Survival factor: ≥0.9

The lumen maintenance factor: 0.96

PARAMETERS FOR LED AND OLED MAINS LIGHT SOURCES:

LED light source replaces a fluorescent light source without integrated ballast of a particular wattage: Not applicable

LOGISTIC DATA:

Packaging method: 20

Number of units in the secondary packaging: 1

Number of units in the packaging: 20

Net unit weight [g]: 223

Grammage [g]: 268

Length of a unit pack [cm]: 11.5

Width of a unit pack [cm]: 4

Height of a unit pack [cm]: 11.5

Weight of a cardboard box [kg]: 5.36

Width of a cardboard box [cm]: 23

Height of a cardboard box [cm]: 25.5

Length of a cardboard box [cm]: 24.5

Volume of a cardboard box [m³]: 0.014369

33750 DULI LED 4W-NW-L-GR

Surface-mounted light fitting

