

33815 ITECH C1 302MATW

Emergency lighting LED

5902052530854

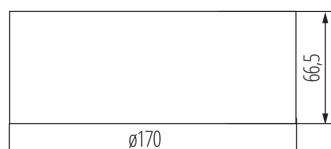

Emergency or anti-panic lighting is used in open space rooms to prevent panic. It allows you to reach a place where you can see the marked escape route as well as for the illumination of the escape route itself, depending on the prism used in the fixture.

PRODUCT PARAMETERS:

Colour: white

Place of assembly: wall mounted, ceiling mounted

Place of application: Indoors

Height [mm]: 66.5

Diameter [mm]: 170

Integrated LED light source: yes

Rated voltage [V]: 220-240 AC

Rated frequency [Hz]: 50

Rated power [W]: 6.4

Maximum power [W]: 2

Class of protection against electric shock: II

Diode type: LED SMD

Luminous flux [lm]: 238

Luminous flux [lm] (emergency-lighting module): 238

Colour temperature: cold white

Ambient temperature range to which the product can be exposed: 10÷40

Battery (type): LiFePO4/C

Battery (parameters): 6,4V 1,5Ah

Operating mode: emergency and network

Application: lighting of escape routes

Fail-safe working time [h]: 3

Automatic test: yes

Enclosure material: plastic

Connection type: Self-clamping block

IP class: 65

PARAMETERS FOR LED AND OLED LIGHT SOURCES:

Correlated colour temperature [K]: 5000

LOGISTIC DATA:

Packaging method: 1

Number of units in the secondary packaging: 1

Number of units in the packaging: 1

33815 ITECH C1 302MATW

Emergency lighting LED

ACCESSORIES:

33830 UCHW PODT OS S2 S3 IT