

33836 ITECH F2 105MATW

Emergency lighting LED

5902052531042

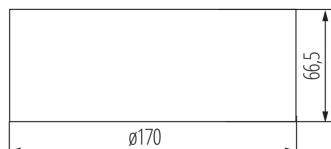

Emergency or anti-panic lighting is used in open space rooms to prevent panic. It allows you to reach a place where you can see the marked escape route as well as for the illumination of the escape route itself, depending on the prism used in the fixture.

PRODUCT PARAMETERS:

Colour: white

Place of assembly: wall mounted, ceiling mounted

Place of application: Indoors

Height [mm]: 66.5

Diameter [mm]: 170

Integrated LED light source: yes

Rated voltage [V]: 220-240 AC

Rated frequency [Hz]: 50

Maximum power [W]: 4.5

Class of protection against electric shock: II

Diode type: LED SMD

Luminous flux [lm]: 499

Luminous flux [lm] (emergency-lighting module): 499

Colour temperature: cold white

Ambient temperature range to which the product can be exposed: 10÷40

Battery (type): LiFePO4/C

Battery (parameters): 6.4V

Operating mode: emergency and network

Application: lighting of escape routes

Fail-safe working time [h]: 1

Automatic test: yes

Enclosure material: plastic

Connection type: Self-clamping block

IP class: 65

PARAMETERS FOR LED AND OLED LIGHT SOURCES:

Correlated colour temperature [K]: 5000

LOGISTIC DATA:

Packaging method: 1

Number of units in the secondary packaging: 1

Number of units in the packaging: 1

33836 ITECH F2 105MATW

Emergency lighting LED

ACCESSORIES:

33830 UCHW PODT OS S2 S3 IT