

35290 LEADIE LED W

LED desk lamp

5905339352903

changeable
COLOUR
temperature

DIMMING
function

MODERN
design



KANLUX LEADIE LED is an elegant standing lamp. It works great as the main desk light, but also as an additional light source in the room. It can also function as a bedside lamp.

TYPE OF LIGHT SOURCE:

Lighting technology used: LED
Non-directional or directional light source: DLS
Mains or non-mains light source: NMLS
Connected light source (CLS): no
Colour-tuneable light source: yes
High luminance light source: no
Anti-glare shield: no
Dimmable: only with specific dimmers

PRODUCT PARAMETERS:

Colour: white
Place of assembly: On the floor
Place of application: Indoors
Minimum distance from the illuminated object: 0,1m
Possibility of dimming only with help of an internal electronic system: yes
Compatible with a dimmer: no
On switch: yes
Length [mm]: 108
Width [mm]: 145
Height [mm]: 395
Diameter [mm]: 146
Integrated LED light source: yes
Rated voltage [V]: 220-240 AC
Rated frequency [Hz]: 50
Maximum power [W]: max 4,6
Class of protection against electric shock: II
Lampshade material: plastic
Diode type: LED SMD
LED module: DE14071H22
Luminous flux [lm]: max 300
Colour temperature: Warm white, white, cold white
Service life [h]: 25000
Number of on/off cycles: ≥15000
Enclosure material: plastic
Extension-arm material: Metal
Connection type: Cable terminated with a plug
Wire length [m]: 1.7
Lamp-heating time [s]: ≤1
Lamp-ignition time [s]: ≤0,5

35290 LEADIE LED W

LED desk lamp

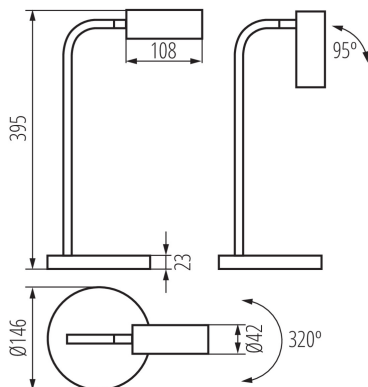

The fixture is movable horizontally [°]: 320

The fixture is movable vertically [°]: 95

IP class: 20

Additional information: The LED light source can only be replaced by qualified personnel (Kanlux service only)

Additional information: The control panel or control equipment can be replaced by the end user

PARAMETERS FOR DIRECTIONAL LIGHT SOURCES:

Peak luminous intensity [cd]: 155

Beam angle [°]: 110

PARAMETERS FOR LED AND OLED LIGHT SOURCES:

Energy consumption in on-mode of the light source (kWh/1000h): 3

Energy efficiency class: D

Useful luminous flux of the light source Φ_{use} [lm]: 370

Useful luminous flux of the light source Φ_{use} [lm]: in wide cone (120°)

Correlated colour temperature [K]: 3000/4500/6500

Colour consistency in McAdam ellipses: ≤ 6

On-mode power of the light source P_{on} [W]: 2,9

Height of the light source [mm]: 35

Width of the light source [mm]: 35

Depth of the light source [mm]: 3

Colour rendering index: 80

Chromaticity coordinates (x): 0.44/0.36/0.313

Chromaticity coordinates (y): 0.403/0.36/0.337

R9 colour rendering index value: 9

Survival factor: 0,9

The lumen maintenance factor: 0,96

LOGISTIC DATA:

Packaging method: 8

Number of units in the secondary packaging: 1

Number of units in the packaging: 8

Net unit weight [g]: 738

Grammage [g]: 1018.75

Length of a unit pack [cm]: 15

Width of a unit pack [cm]: 15

Height of a unit pack [cm]: 43

Weight of a cardboard box [kg]: 8.15

Width of a cardboard box [cm]: 32.5

Height of a cardboard box [cm]: 45

Length of a cardboard box [cm]: 61.5

Volume of a cardboard box [m³]: 0.089944

35290 LEADIE LED W

LED desk lamp